

Installing the NoZone[®] Ozone Scrubber

Cat. #1090-20-1 (115V) and Cat. #1090-20-2 (220V)

» Identify System Components

Unpack and identify all components before attempting to assemble the system.

- Ozone filtration unit
- Six foot section of 4" diameter flexible ducting
- Adjustable metal clamps (2)

Report any discrepancies or shortages immediately to SciGene Customer Service [custserv@scigene.com].

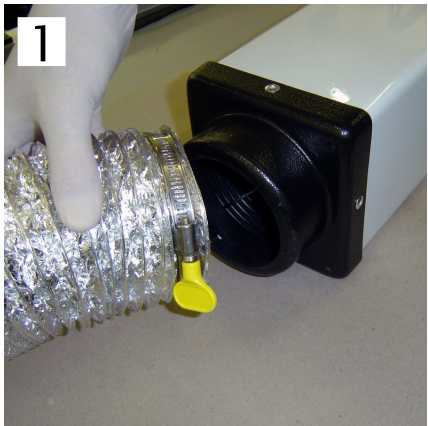

Slide the ducting (silver) over the flange of the scrubber marked as the air exit.



Secure the duct to the flange by tightening the clamp thumbscrew (yellow).

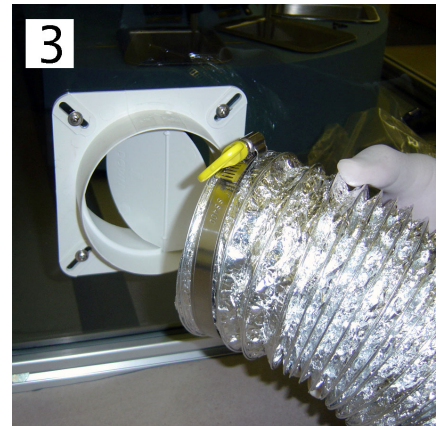

If using a NoZone[®] Enclosure, slide the ducting over the side flange (white) and tighten.

» Step 1. Attach the Ducting

Place one of the adjustable metal clamps provided around one end of the flexible ducting and slide the end of the duct over the flange of the scrubber marked as the air exit. Secure the duct to the flange by tightening the clamp thumbscrew.

Repeat this process with the opposite end of the duct on the flange that protrudes on the side of the NoZone[®] Enclosure.

» Step 2. Power On

Plug the unit into a suitable power source and switch on power. You will hear a hum as the fan powers up and air begins to flow through the unit.

When used under normal atmospheric conditions, the ozone level within the NoZone Enclosure is reduced to below 5 ppb in less than 10 minutes after turning on the scrubber and is maintained at this level indefinitely with the scrubber operating and the door closed. Because of the slight positive pressure within the enclosure, the door can be opened for up to 2 minutes before a significant rise in ozone level is detected.